



乾式螺旋真空泵浦

Dry Screw Vacuum Pump

三錦機器股份有限公司

SUNNY KING MACHINERY CO. LTD.



CAT - No. 250708

Vacuum Essential

三錦公司三十餘年來致力於真空技術開發及產業應用，其真空設備性能及可靠度早已廣受各界肯定。SDV 系列螺旋乾式真空泵採用全新設計的乾式泵浦螺旋轉子，可抽取凝結液或微顆粒物質。其創新的設計及優異性能可協助產業提升高階製程應用能力。

Features

■ 專利V-screw：高效率、高信賴

專利設計V-screw螺旋轉子採用全密閉式螺旋線形，真空排氣容積效率優異。新設計的轉子構形比起傳統螺旋轉子構形在節省能源消耗有更優異的表現。此外，一體 (One-piece) 加工成形的螺旋轉子不僅可提昇設備可靠度，亦可大幅簡化維修保養作業。

■ 綠色產品

乾淨：泵浦不需用水或油作密封液或潤滑，具高潔淨度，不會污染製程。

安靜：轉子旋轉時無金屬接觸，運轉超靜音。

節約：排氣溫度低，減少冷卻水用量。

■ 安全守護：功能齊全，簡單易用的監控管理系統

乾式螺旋真空泵的監控系統可協助廠內工程師安排保養時程，做好即時性資產設備風險管理並大幅減少系統無預警停機的機率。

運轉狀態監測：

可提供總運轉時數、啟動次數、冷卻水流量、氮氣壓力、運轉溫度以及馬達電流、電壓狀態監測。

運轉異常警告：

泵浦過熱、馬達過電流、機油異常、氮氣壓力異常警告等。

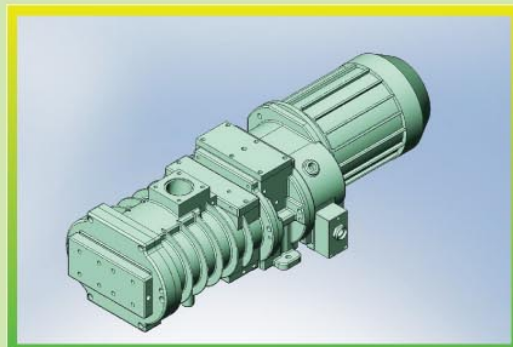

Sunny King Machinery Co., Ltd. is renowned for its vacuum technology in Taiwan. We have more than 30 years of experience in vacuum technology development and industrial applications. The new SDV Dry Screw Vacuum Pumps, with a brand new design of spiral-shape rotors, makes it possible to draw condensed drops or micro grains. Its creative design and superior performance can help various product manufacturers to advance their high-end manufacturing technology.

■ Patented V-screw: High Efficiency & Reliability

The patented V-screw is a fully-closed design. Its brand new designed screw shape runs at an excellent pumping speed and can save energy consumption more than other dry screw vacuum pumps which adopt a conventional screw profile. In addition, the state-of-art one-piece machine forming V-screw not only enhances the reliability of dry vacuum pump but also simplify the pump maintenance works sharply.

■ Green Product

Clean : Neither water nor oil is needed for sealant or lubricant. As a result, manufacturing process will not be contaminated.

Quiet : There is no metal-to-metal contact when the screw is rotating, so only very low noise will be produced.

Economical : Lower emission temperature results in lower cooling water consumption.

■ Safe Guard: Complete and easy-to-use monitoring system

The dry screw vacuum pump management system helps factory engineers to arrange maintenance schedule and achieve real-time assets risk management. It can significantly reduce the possibility of unexpected system failure.

Pump status monitoring :

Total running hours/pump start counter / cooling water flow gauge/nitrogen pressure switch / pump temperature monitoring / motor current monitoring/ motor voltage monitoring

Pump status warning :

Pump over heat alarm / motor over current alarm / lube alarm/purge nitrogen pressure alarm

技術規格 Technical Specification

Model		SDV - A40	SDV - A50	SDV - A75
Pumping Speed (L/min)		2,050	2,600	4,100
Ultimate Pressure	Torr	0.005	0.005	0.005
	Pa	0.67	0.67	0.67
Motor Power (KW/HP/Pole)		3 / 4 / 2	4 / 5 / 2	5.5 / 7.5 / 2
Inlet Flange (inch)		2	2	2
Outlet Flange (inch)		1.5	1.5	1.5
Cooling Water Supply (L/min)		2	2	3
Electric Power Supply	3 Phase AC 200~440V 50 / 60Hz			
Sealing Purge N ₂ Supply (L/min)		3	3	3
Approx. Weight (kg)		260	265	275
Dimension L X W X H (mm)		1200 X 502 X 700	1200 X 502 X 700	1200 X 502 X 700

- 標準法蘭為 JIS 5K FF 規格，選用法蘭可提供 JIS 10K FF / ANSI 150 FF 或 NW 真空法蘭規格。
- 客戶可指定防爆等級設計。
- 本公司不斷致力於產品改良，本型錄記載之產品外型規格如有異動恕不另行通知。
- The standard Flange is JIS 5K FF ; JIS 10K FF, ANSI 150 FF or NW flange is optional.
- Customized explosive-proof design is optional.
- Because we are constantly working to improve performance and upgrade our products, specifications and diagrammatic representations in this catalog may change without notice.

SDV-A40 / SDV-A50 / SDV-A75

Butt Joint Flange Specification

Model	JIS 10K	ANSI #150	NW
	Inlet x Outlet		
SDV-A40	2" X 1.5"	2" X 1.5"	50 X 40
SDV-A50	2" X 1.5"	2" X 1.5"	50 X 40
SDV-A75	2" X 1.5"	2" X 1.5"	50 X 40

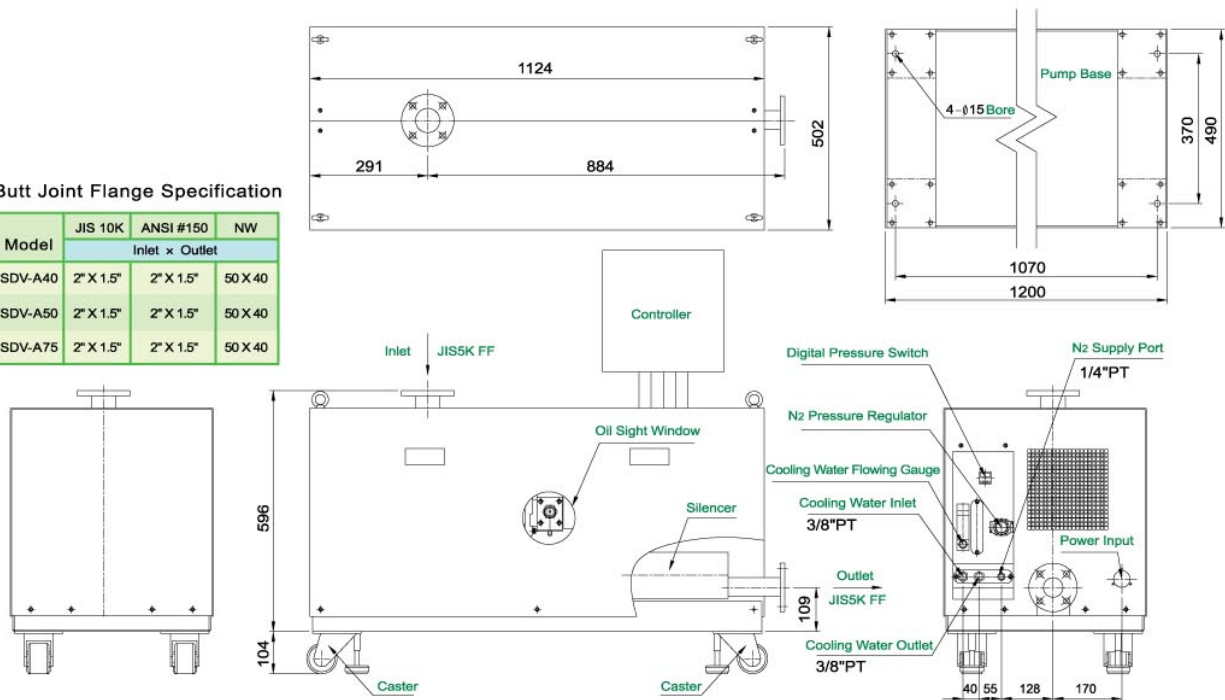

- 台北公司：104台北市中山區民生東路二段147巷5弄12號
Office : No.12, Alley 5, Lane 147, Sec. 2, Minsheng E. Rd.
Zhongshan District, Taipei City 104, Taiwan.
Tel : +886-2-2509-0049 Fax : +886-2-2509-4194
- 新莊廠：242台北縣新莊市新樹路234巷1號
Sinhuang Factory : No.1, Lane234, Sinshu Road.
Sinhuang City, Taipei County 242, Taiwan.
Tel : +886-2-2202-0224~6 Fax : +886-2-2202-7354
- 中壢廠：320桃園縣中壢市南園路16號 (中壢工業區)
Jhongli Factory : No.16, Nanyuan Rd. Jhongli City,
Taoyuan County 320, Taiwan.
Tel : +886-3-451-1969 Fax : +886-3-452-8602
- 台中：407台中市西屯區工業42路33號 ■ 高雄：807高雄市三民區中華二路199號
Tel : +886-4-2359-4673 Tel : +886-7-321-1745~6
Fax : +886-4-2359-4723 Fax : +886-7-321-1747
E-mail : ccpump@ms57.hinet.net E-mail : T3211745@ms41.hinet.net



 **三錦機器股份有限公司**
SUNNY KING MACHINERY CO. LTD.

■ 公司網址

Website : www.sunny-king.com.tw

■ 業務資訊

Product Information : skpump@sunny-king.com.tw

Copyright ©2007 Sunny King Machinery Co., Ltd. All Rights Reserved.

記事欄：

